



### 3. Normal use and installation conditions

#### 3.1 Normal use conditions

3.1.1 Ambient air temperature:  $-5^{\circ}\text{C} \sim +40^{\circ}\text{C}$ , and the average temperature within 24h does not exceed  $+35^{\circ}\text{C}$ .

3.1.2 Altitude: The altitude of the installation site does not exceed 2000m.

3.1.3 Humidity: When the highest temperature is  $+40^{\circ}\text{C}$ , the relative humidity of the air does not exceed 50%, and higher relative humidity is allowed at lower temperatures, for example, up to 90% at  $20^{\circ}\text{C}$ . Special measures should be taken for the occasional condensation due to temperature changes.

3.1.4 Pollution degree: Level 3.

#### 3.2 Installation conditions

3.2.1 Install in a place where there is no significant shaking, shock and vibration, and no rain or snow; in a medium without explosion hazard; where there is no place that is sufficient to corrode metal and damage insulation (including conductive dust);

3.2.2 Installation category: Class III.

#### 3.3 Transport and storage conditions

3.3.1 The following temperature ranges are suitable for transportation and storage: between  $-25^{\circ}\text{C}$  and  $+55^{\circ}\text{C}$ . Up to  $+70^{\circ}\text{C}$  in a short time (24h)

Note: When the above-mentioned normal use, installation, transportation and storage conditions are exceeded, the user should reach a special agreement with the company.

## NF2 Series Load Switches

### 1. General

NF2 series load switch (hereinafter referred to as switch), mainly used in electrical circuits with AC 50Hz or 60Hz, rated working voltage up to 690V, and rated working current up to 125A. It can be used to isolate faulty equipment or perform power outage maintenance. It can be used as the main switch of machine tools, fans, and pumps, and can also be used as the start-stop switch of small-capacity motors. Standards compliant: IEC/EN 60947-3, GB/T 14048.3

### 2. Type designation

#### 2.1 Load switch model and its meaning

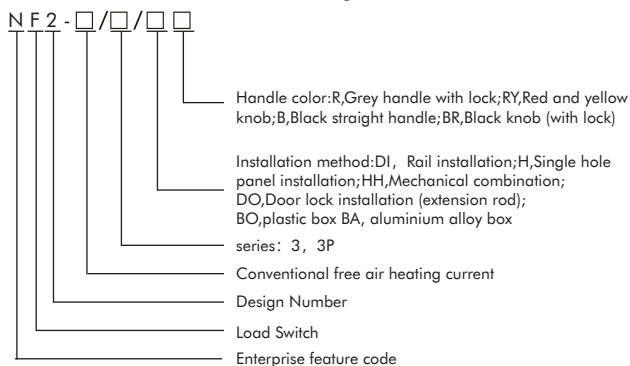

Note: 4-pole products are realized by means of 3 poles + additional poles.

#### 2.2 Additional pole model and its meaning

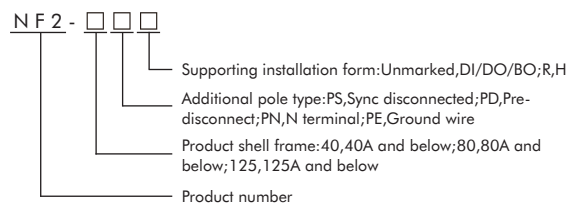

#### 2.3 Auxiliary pole model and its meaning

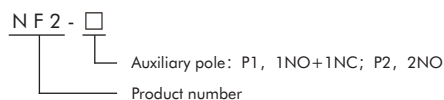

#### 2.4 Terminal cover model and its meaning

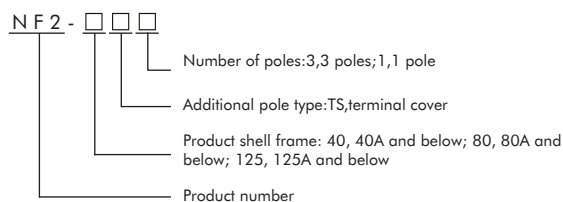

## 4. Technical data

Table 1 Main technical parameters

Model		NF2						
Frame grade		NF2-40			NF2-80		NF2-125	
Rated insulation voltage $U_i$ (V)		800						
Rated impulse withstand voltage $U_{imp}$ (kV)		8						
Conventional free air heating current $I_{th}$ (A)		25	32	40	63	80	100	125
Rated working current $I_e$ (A, AC-23A)	415V	25	32	40	63	80	100	125
	500V	25	25	25	63	63	80	100
	690V	25	25	25	40	40	63	63
Rated short-time withstand current $I_{cw,1s}$ (kA)		1.26			1.5		2.75	
Rated short-circuit making capacity $I_{cm}(kA)$		1.8			2.1		3.9	
Number of poles		3P, 3P+N						
Wiring capacity (hard wire,cross-sectional area)(mm <sup>2</sup> )		1.5~16			2.5~35		10~70	
Tightening torque of terminal screws (N.m)		1.2~1.4			2.5~2.8		3.5~4	
Electrical life (times)		2000						
Mechanical life (times)		100000						
Protection level		IP20, IP65 (With protective shell)						

Table 2 Main technical parameters of HH mechanical assembly

Model		NF2-HH (mechanical combination)								
Specification		IM2 mechanical combination system: use 6-8 pole combination			IM31 mechanical interlocking structure: for 3/4 pole I - I + II - II			IM32 mechanical interlocking mechanism: used for 3/4 pole I -O - II conversion		
Rated insulation voltage $U_i$ (V)		800								
Rated impulse withstand voltage $U_{imp}$ (kV)		8								
Conventional free air heating current $I_{th}$ (A)		63	80	100	63	80	100	63	80	100
Rated working current $I_e$ (A, AC-23A)	415V	63	80	80	63	80	80	63	80	80
	500V	63	63	63	63	63	63	63	63	63
	690V	40	40	40	40	40	40	40	40	40
Rated short-time withstand current $I_{cw,1s}$ (kA)		1.5								
Number of poles		6, 8								
Wiring capacity (hard wire,cross-sectional area)(mm <sup>2</sup> )		2.5~35								
Tightening torque of terminal screws (N.m)		2.5~2.8								
Electrical life (times)		2000								
Mechanical life (times)		100000								

## 5. Structural features and working principle

5.1 The switch is mainly composed of a handle, an operating mechanism, a contact system, a shell, and accessories. The operating mechanism adopts spring energy storage, the connection and breaking speed has nothing to do with the speed of the operating handle, ensuring the connection and breaking capacity of the product; the contact system adopts a double-breakpoint bridge structure; the wiring method adopts the wire frame method; the installation method adopts the front panel Installation (rail installation, screw installation), panel installation; the shell is made of flame-retardant reinforced polyamide material, which has good flame-retardant performance, dielectric performance and carbonization resistance.

5.2 The switch 3-pole body adds some standard accessories and can be combined into a 6/8-pole load switch or 3/4-pole transfer switch, and a neutral pole, grounding pole or auxiliary contact can also be added;

### 6.Overall and mouting dimensions

The outline and installation dimensions of the switch are shown in following. See the box sticker for model specifications and weight.

NF2-40/DI

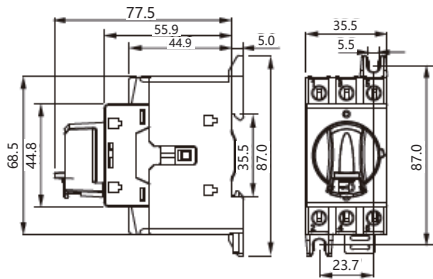

NF2-80/DI

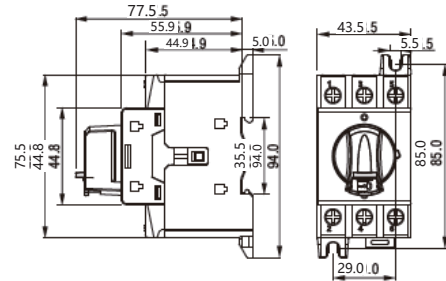

NF2-125/DI

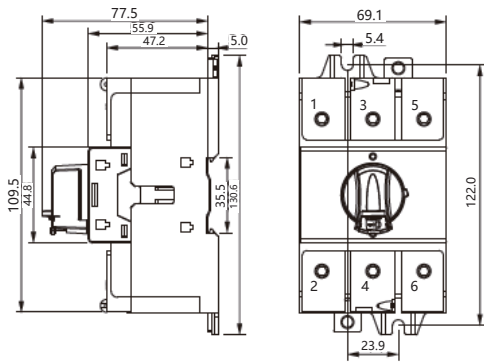

NF2-40/H

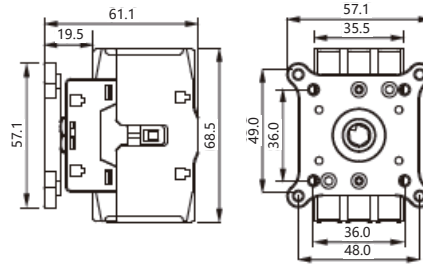

NF2-80/H

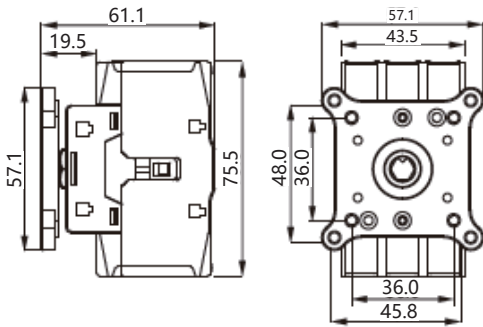

NF2-125/H

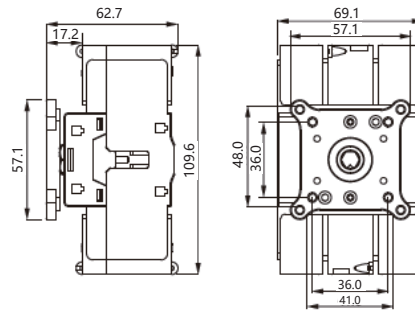

NF2-40/TS

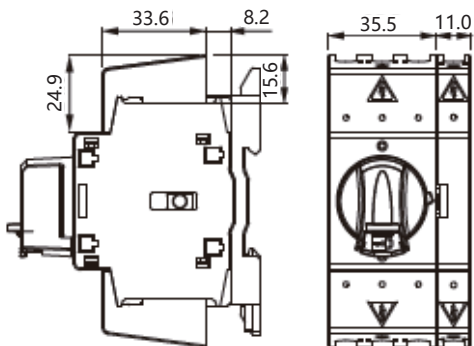

NF2-80/TS

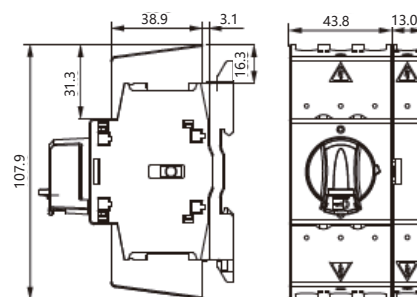

NF2-125/TS

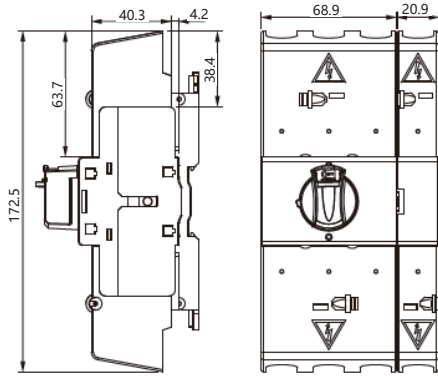

NF2-80/HTS

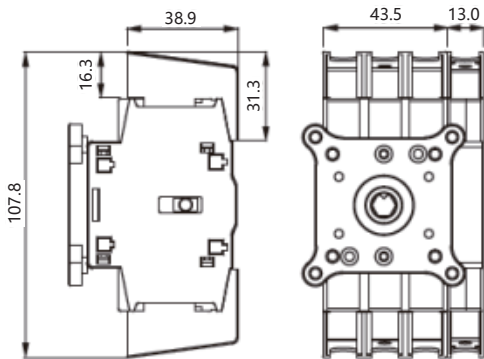

NF2-40/PN\PS\PD\PE

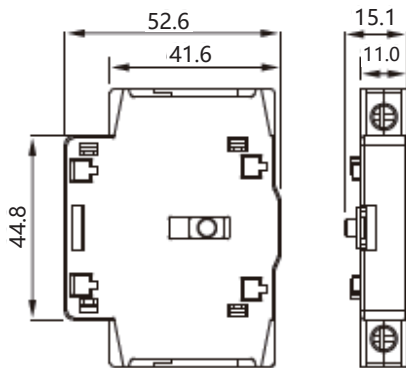

NF2-125/PN\PS\PD\PE

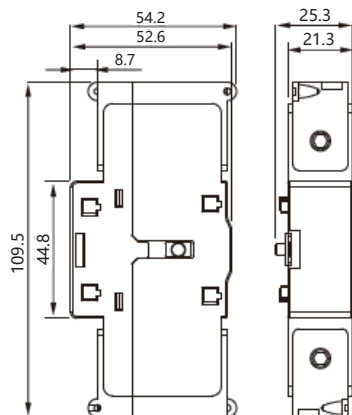

NF2-40/HTS

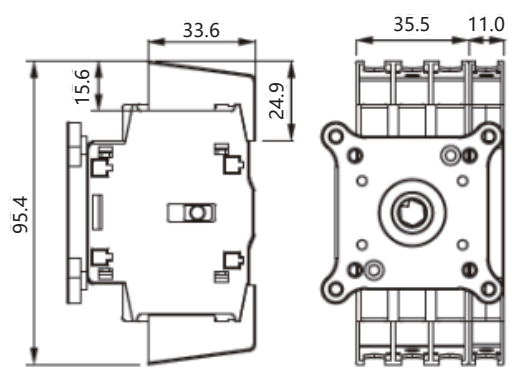

NF2-125/HTS

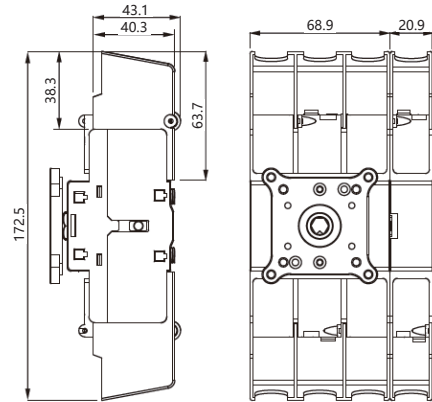

NF2-80/PN\PS\PD\PE

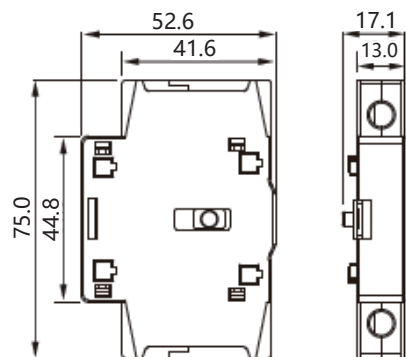

NF2-40/PNR\PSR\PDR\PER

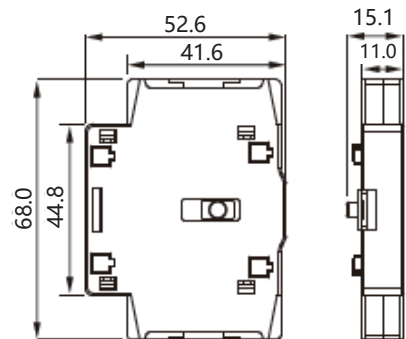

NF2-40/PNR\PSR\PDR\PER

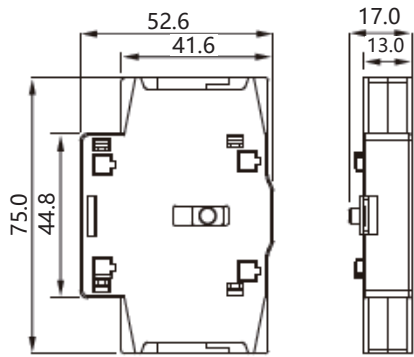

NF2-P1, P2

NF2-125/PNR\PSR\PDR\PER

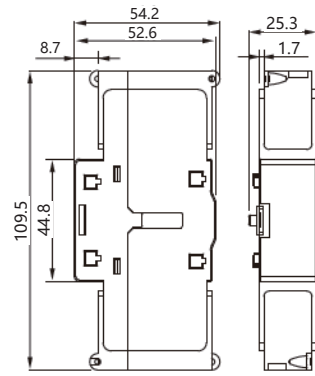

NF2-P1, P2

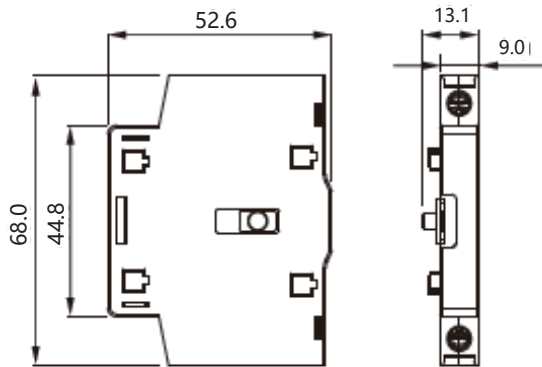

NF2-HH

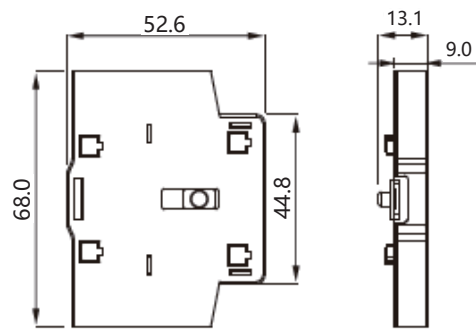

NF2-P1R, P2R

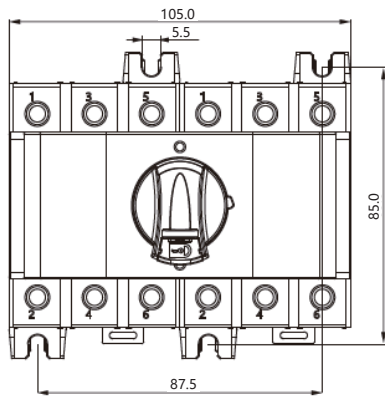

NF2-40/BO

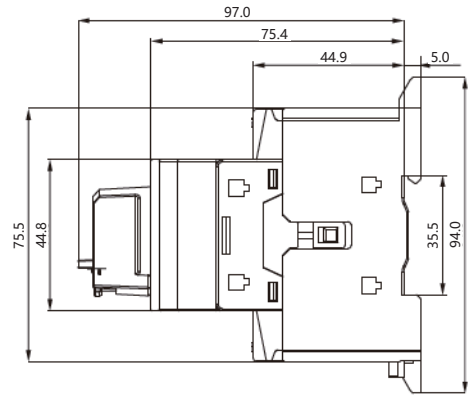

NF2-80/BO

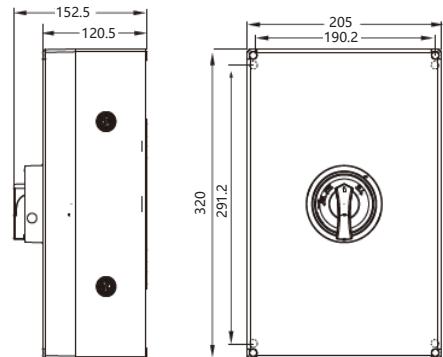
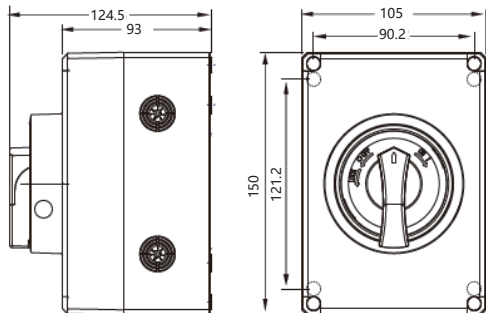

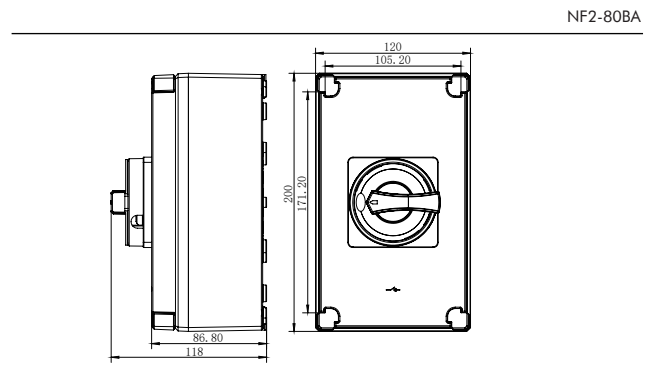
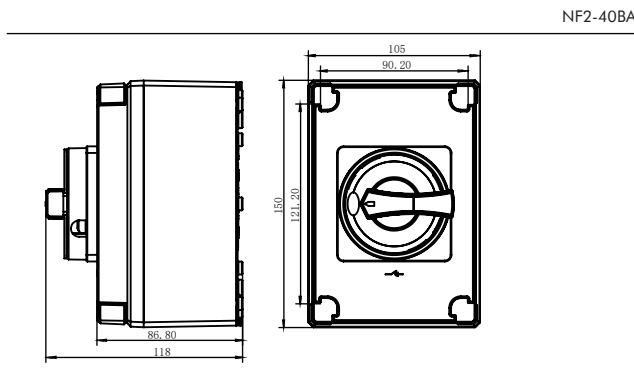
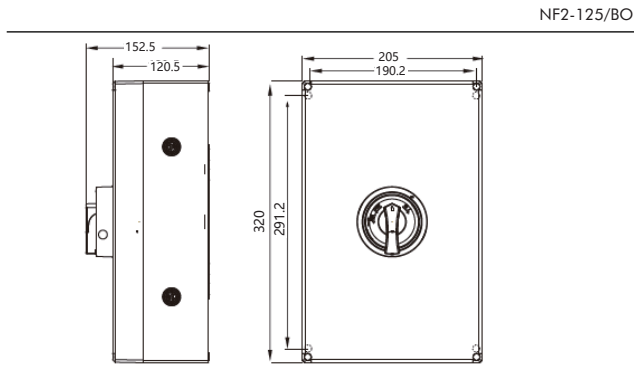

## 7. Order information

### 7.1 Check before installation

7.1.1 The technical data on the nameplate meets actual requirements.

7.1.2 Appearance: clean, intact parts, no loose fasteners.

7.1.3 Check the operating performance: perform 3 times of closing and opening operations, the product action is flexible and reliable; the handle points to the "ON" position, all contacts are in the on state; the handle points to the "OFF" position, and all the contacts are in the off state.

### 7.2 Installation method and precautions

7.2.1 Screw installation: confirm that the switch is in the off state → open a hole on the mounting plate and tap the screw → connect the switch and the mounting plate with screws and tighten

7.2.2 Guide rail installation: confirm that the switch is off → the guide rail is fixed in the cabinet → install the switch as shown in Figure 26

7.2.3 Panel installation: confirm that the switch is in the off state → the mounting plate is open → the screw assembly connects the body, the installation panel and the installation plate → the name plate → the cover → the handle → tighten the screw. As shown in Figure 27

Figure 26 Guide rail installation sketch

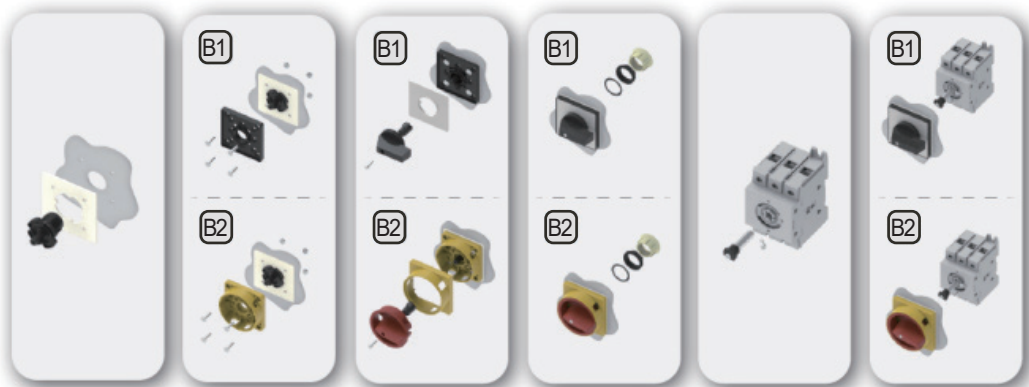
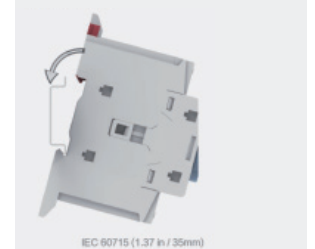
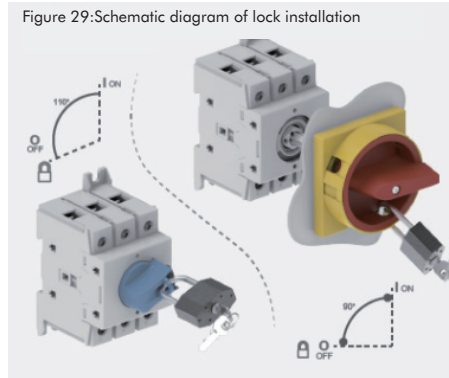
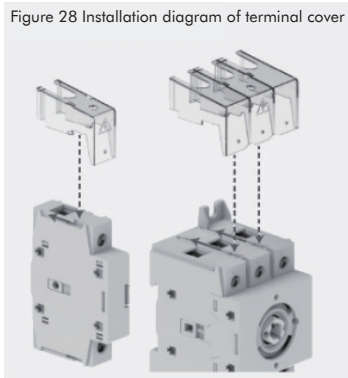

Figure 27 Panel installation sketch

7.2.4 Terminal cover and lock installation: as shown in Figure 28,29



7.2.5 Additional auxiliary contact/additional fourth pole installation: as shown in Figure 30,31

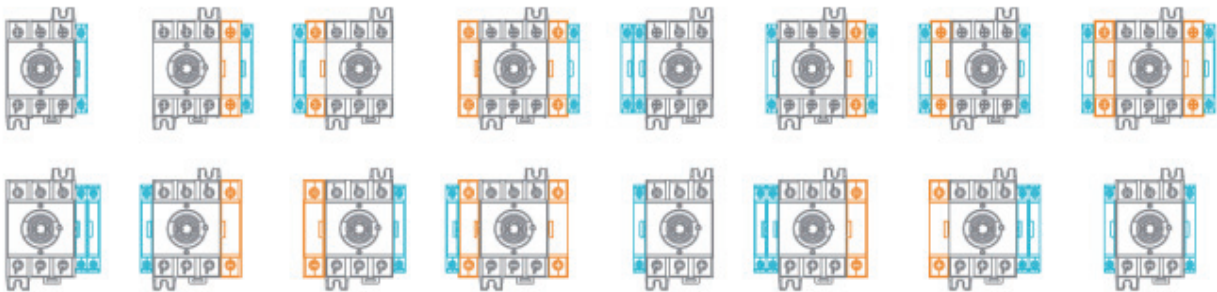

Figure 30 Schematic diagram of accessory pole/auxiliary contact matching

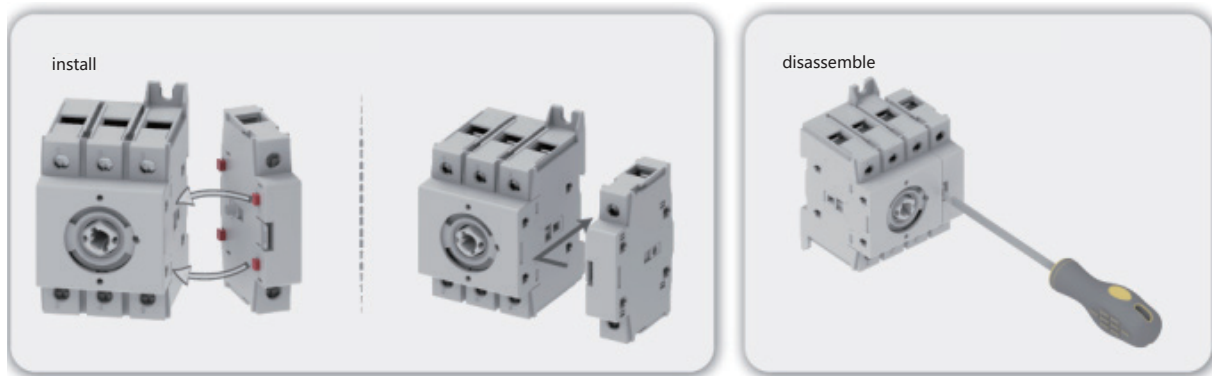

Figure 31 Schematic diagram of attachment pole installation

## 8. Maintenance and storage period

### 8.1 Daily maintenance

Take appropriate measures to remove dust, water vapor, conductive dust and corrosive substances. Non-professionals of the company are not allowed to disassemble and repair.

### 8.2 Maintenance and maintenance during operation

8.2.1 Confirm that the wiring terminals are in good contact, there is no looseness, and the wire connection is reliable.

8.2.2 During use, all parts of the product should be checked frequently to ensure that no moving parts are stuck and fasteners are not loosened to ensure safety and reliability. If the parts are damaged, they should be replaced in time.

### 8.3 Maintenance cycle

It is recommended to check and maintain it once a month.

### 8.4 Long-term use and storage period

The product should be disconnected when not in use, and should be stored in a ventilated, dry, non-corrosive gas warehouse. The product or packaging should not be placed directly on the ground to avoid damage.

## 9. Warranty period and environmental protection and other legal regulations

### 9.1 Warranty period

Under normal storage and transportation conditions, the product packaging or the product itself is intact, and the product has a warranty period of 24 months from the date of production. The following conditions are not covered by the warranty:

- 1) Damage caused by improper use, storage and maintenance by the user.
- 2) Damage caused by the organization or personnel not designated by the company, or the user's disassembly, assembly and maintenance.
- 3) The product has exceeded the warranty period.
- 4) Damage caused by force majeure.

### 9.2 Environmental protection

In order to protect the environment, when this product or its components are scrapped, please dispose of them properly as industrial waste; or hand them to a recycling station for classification, disassembly, recycling, etc. in accordance with relevant national regulations.

## 10. Ordering instructions

10.1 State the model, number, delivery time, place, unit and consignee when ordering;

10.2 Order example: NF2-25/3HRY 10 units. NF2-25 3-pole single-hole panel mounting 10 sets of red and yellow knobs.

10.2.1 If you need to order a 4-pole product, it should include the main body + additional poles: such as NF2-25/3DIR 10 sets + NF2-40PS 10 sets. NF2-25 3-pole guide rail installation Blue knob 10 sets +40 frame frame Synchronously disconnect 10 sets of additional poles.

10.2.3 If you need to order a 4-pole product + auxiliary, it should include the main body + additional pole + auxiliary pole: such as NF2-32/3DOB 10 sets + NF2-40PD 10 sets + NF2-P1 10 sets. NF2-25 3-pole door lock installation Black straight handle 10 sets +40 shell frame 10 sets of pre-disconnected additional poles + 10 sets of NO1NC auxiliary

## 11. Accessories overview

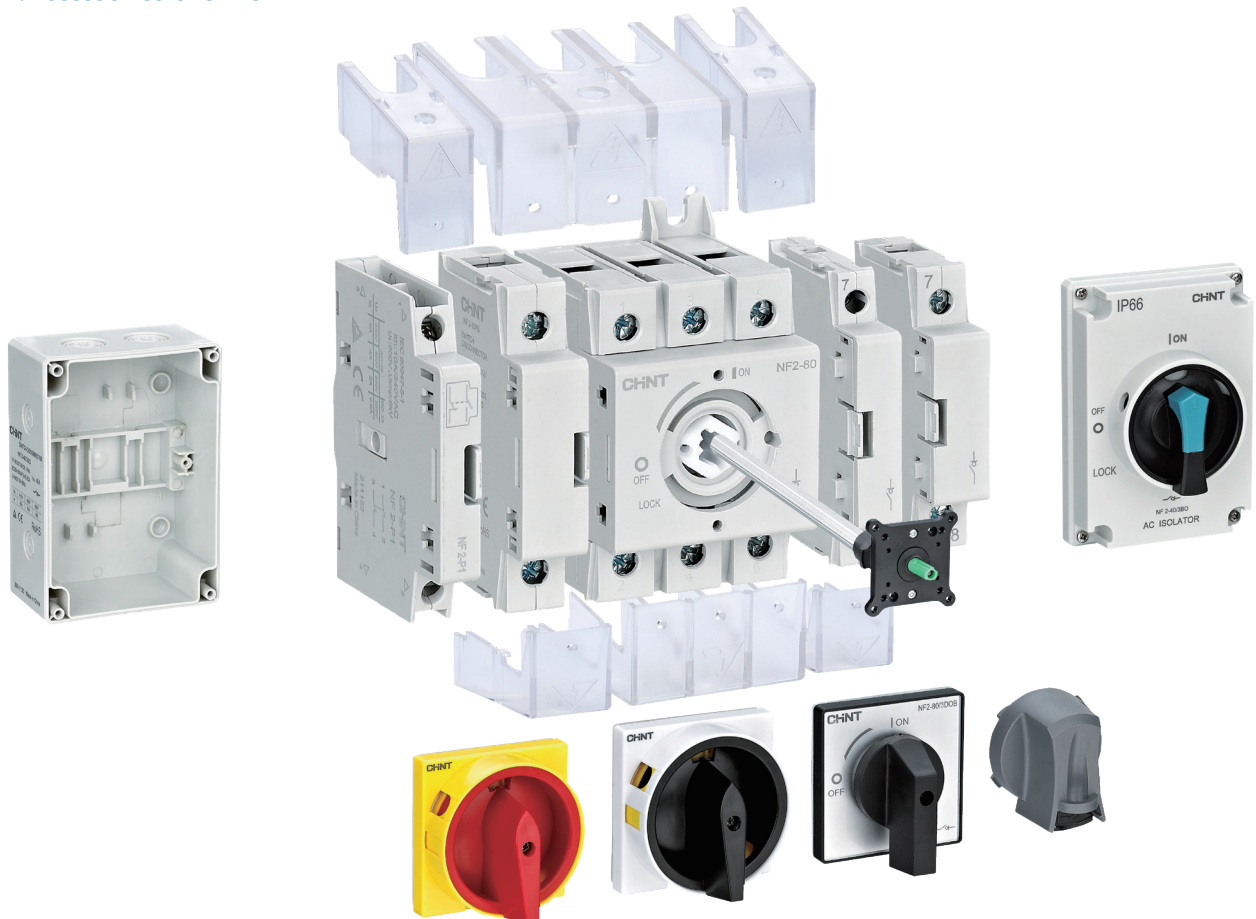

Product Reference	Ordering Code	Description
G NF2 B(R)	557289	gray handle
G NF2 BY(R)	557288	lockable black handle
G NF2 DO POLE 200mm(R)	557290	200mm shaft, for DO DIN rail installation products
G NF2 DO ROD 300mm(R)	540343	300mm shaft, for DO DIN rail installation products
G NF2 DO 200mm(R)	511511	200mm shaft package, for HH mechanical combination products
G NF2 DO 300mm(R)	511512	300mm shaft package, for HH mechanical combination products
G NF2 RY(R)	540342	lockable red and yellow handle
G NF2-100/3BO (R)	324165	100A, 3P, plastic enclosure, with lockable black handle
G NF2-100/3BORY(R)	557277	100A, 3P, plastic enclosure, with lockable red and yellow handle
G NF2-100/3DIR (R)	324164	100A, 3P, DIN rail installation, with gray handle
G NF2-100/3DO(R)	557279	100A, 3P, DIN rail installation, without handle and extension shaft
G NF2-100/3DOB (R)	324144	100A, 3P, DIN rail installation, with straight black handle and 135mm extension shaft
G NF2-100/3DOBR (R)	324145	100A, 3P, DIN rail installation, with lockable black handle and 135mm extension shaft
G NF2-100/3DORY (R)	324143	100A, 3P, DIN rail installation, with lockable red and yellow handle, and 135mm extension shaft
G NF2-100/3H(R)	557286	100A, 3P, panel installation, without handle
G NF2-100/3HB (R)	324141	100A, 3P, panel installation, with gray handle
G NF2-100/3HBR (R)	324142	100A, 3P, panel installation, with lockable black handle
G NF2-100/3HRY (R)	324140	100A, 3P, panel installation, with lockable red and yellow handle
G NF2-100/HHRIM2 (R)	324170	"100A, 6P, mechanical combination product, DIN rail installation, with gray handle 2-positions, all poles closed on the left and opened on the middle"
G NF2-100/HHRIM31 (R)	324173	"100A, 6P, mechanical combination product, DIN rail installation, with gray handle 3-positions, all poles closed on the middle, left 3 poles closed on the left position, right 3 poles closed on the right position"
G NF2-100/HHRIM32 (R)	324176	"100A, 6P, mechanical combination product, DIN rail installation, with gray handle 3-positions, all poles opened on the middle, left 3 poles closed on the left position, right 3 poles closed on the right position"
G NF2-125/3BO (R)	324167	125A, 3P, plastic enclosure, with lockable black handle
G NF2-125/3BORY(R)	557278	125A, 3P, plastic enclosure, with lockable red and yellow handle
G NF2-125/3DIR (R)	324166	125A, 3P, DIN rail installation, with gray handle
G NF2-125/3DO(R)	557280	125A, 3P, DIN rail installation, without handle and extension shaft
G NF2-125/3DOB (R)	324150	125A, 3P, DIN rail installation, with straight black handle and 135mm extension shaft
G NF2-125/3DOBR (R)	324151	125A, 3P, DIN rail installation, with lockable black handle and 135mm extension shaft
G NF2-125/3DORY 300mm(R)	529743	125A, 3P, DIN rail installation, with lockable red and yellow handle, and 300mm extension shaft
G NF2-125/3DORY (R)	324149	125A, 3P, DIN rail installation, with lockable red and yellow handle, and 135mm extension shaft
G NF2-125/3H(R)	557287	125A, 3P, panel installation, without handle
G NF2-125/3HB (R)	324147	125A, 3P, panel installation, with gray handle
G NF2-125/3HBR (R)	324148	125A, 3P, panel installation, with lockable black handle
G NF2-125/3HRY (R)	324146	125A, 3P, panel installation, with lockable red and yellow handle
G NF2-125PD (R)	324204	additional pole for 125A frame size, pre-disconnected, DIN rail installation

Product Reference	Ordering Code	Description
G NF2-125PDR (R)	324215	additional pole for 125A frame size, pre-disconnected, panel installation
G NF2-125PE (R)	324205	additional pole for 125A frame size, terminal for grounding, DIN rail installation
G NF2-125PER (R)	324217	additional pole for 125A frame size, terminal for grounding, panel installation
G NF2-125PN (R)	324206	additional pole for 125A frame size, terminal for N pole, DIN rail installation
G NF2-125PNR (R)	324218	additional pole for 125A frame size, terminal for N pole, panel installation
G NF2-125PS (R)	324203	additional pole for 125A frame size, sync disconnected, DIN rail installation
G NF2-125PSR (R)	324216	additional pole for 125A frame size, sync disconnected, panel installation
G NF2-125TS1 (R)	324224	Transparent terminal cover for 125A frame size, 1P
G NF2-125TS3 (R)	324223	Transparent terminal cover for 125A frame size, 3P
G NF2-25/3BO (R)	324154	25A, 3P, plastic enclosure, with lockable black handle
G NF2-25/3BORY(R)	557272	25A, 3P, plastic enclosure, with lockable red and yellow handle
G NF2-25/3DIR (R)	324155	25A, 3P, DIN rail installation, with gray handle
G NF2-25/3DO(R)	540337	25A, 3P, DIN rail installation, without handle and extension shaft
G NF2-25/3DOB (R)	324114	25A, 3P, DIN rail installation, with straight black handle and 135mm extension shaft
G NF2-25/3DOBR (R)	324115	25A, 3P, DIN rail installation, with lockable black handle and 135mm extension shaft
G NF2-25/3DORY (R)	324113	25A, 3P, DIN rail installation, with lockable red and yellow handle, and 135mm extension shaft
G NF2-25/3H(R)	557281	25A, 3P, panel installation, without handle
G NF2-25/3HB (R)	324111	25A, 3P, panel installation, with gray handle
G NF2-25/3HBR (R)	324112	25A, 3P, panel installation, with lockable black handle
G NF2-25/3HRY (R)	324110	25A, 3P, panel installation, with lockable red and yellow handle
G NF2-32/3BO (R)	324157	32A, 3P, plastic enclosure, with lockable black handle
G NF2-32/3BORY(R)	557273	32A, 3P, plastic enclosure, with lockable red and yellow handle
G NF2-32/3DIR (R)	324156	32A, 3P, DIN rail installation, with gray handle
G NF2-32/3DO(R)	540338	32A, 3P, DIN rail installation, without handle and extension shaft
G NF2-32/3DOB (R)	324120	32A, 3P, DIN rail installation, with straight black handle and 135mm extension shaft
G NF2-32/3DOBR (R)	324121	32A, 3P, DIN rail installation, with lockable black handle and 135mm extension shaft
G NF2-32/3DORY (R)	324119	32A, 3P, DIN rail installation, with lockable red and yellow handle, and 135mm extension shaft
G NF2-32/3H(R)	557282	32A, 3P, panel installation, without handle
G NF2-32/3HB (R)	324117	32A, 3P, panel installation, with gray handle
G NF2-32/3HBR (R)	324118	32A, 3P, panel installation, with lockable black handle
G NF2-32/3HRY (R)	324116	32A, 3P, panel installation, with lockable red and yellow handle
G NF2-40/3BO (R)	324159	40A, 3P, plastic enclosure, with lockable black handle
G NF2-40/3BORY(R)	557274	40A, 3P, plastic enclosure, with lockable red and yellow handle
G NF2-40/3DIR (R)	324158	40A, 3P, DIN rail installation, with gray handle

Product Reference	Ordering Code	Description
G NF2-40/3DO(R)	540339	40A, 3P, DIN rail installation, without handle and extension shaft
G NF2-40/3DOB (R)	324126	40A, 3P, DIN rail installation, with straight black handle and 135mm extension shaft
G NF2-40/3DOBR (R)	324127	40A, 3P, DIN rail installation, with lockable black handle and 135mm extension shaft
G NF2-40/3DORY 300mm(R)	529741	40A, 3P, DIN rail installation, with lockable red and yellow handle, and 300mm extension shaft
G NF2-40/3DORY (R)	324125	40A, 3P, DIN rail installation, with lockable red and yellow handle, and 135mm extension shaft
G NF2-40/3H(R)	557283	40A, 3P, panel installation, without handle
G NF2-40/3HB (R)	324123	40A, 3P, panel installation, with gray handle
G NF2-40/3HBR (R)	324124	40A, 3P, panel installation, with lockable black handle
G NF2-40/3HRY (R)	324122	40A, 3P, panel installation, with lockable red and yellow handle
G NF2-40PD (R)	324195	additional pole for 40A frame size, pre-disconnected, DIN rail installation
G NF2-40PDR (R)	324207	additional pole for 40A frame size, pre-disconnected, panel installation
G NF2-40PE (R)	324198	additional pole for 40A frame size, terminal for grounding, DIN rail installation
G NF2-40PER (R)	324211	additional pole for 40A frame size, terminal for grounding, panel installation
G NF2-40PN (R)	324197	additional pole for 40A frame size, terminal for N pole, DIN rail installation
G NF2-40PNR (R)	324209	additional pole for 40A frame size, terminal for N pole, panel installation
G NF2-40PS (R)	324194	additional pole for 40A frame size, sync disconnected, DIN rail installation
G NF2-40PSR (R)	324208	additional pole for 40A frame size, sync disconnected, panel installation
G NF2-40TS1 (R)	324220	Transparent terminal cover for 40A frame size, 1P
G NF2-40TS3 (R)	324219	Transparent terminal cover for 40A frame size, 3P
G NF2-63/3BO (R)	324161	63A, 3P, plastic enclosure, with lockable black handle
G NF2-63/3BORY(R)	557275	63A, 3P, plastic enclosure, with lockable red and yellow handle
G NF2-63/3DIR (R)	324160	63A, 3P, DIN rail installation, with gray handle
G NF2-63/3DO(R)	540340	63A, 3P, DIN rail installation, without handle and extension shaft
G NF2-63/3DOB (R)	324132	63A, 3P, DIN rail installation, with straight black handle and 135mm extension shaft
G NF2-63/3DOBR (R)	324133	63A, 3P, DIN rail installation, with lockable black handle and 135mm extension shaft
G NF2-63/3DORY (R)	324131	63A, 3P, DIN rail installation, with lockable red and yellow handle, and 135mm extension shaft
G NF2-63/3H(R)	557284	63A, 3P, panel installation, without handle
G NF2-63/3HB (R)	324129	63A, 3P, panel installation, with gray handle
G NF2-63/3HBR (R)	324130	63A, 3P, panel installation, with lockable black handle
G NF2-63/3HRY (R)	324128	63A, 3P, panel installation, with lockable red and yellow handle
G NF2-63/HHDOBRIM2 300mm(R)	511513	"63A, 6P, mechanical combination product, DIN rail installation, with lockable black handle and 300mm extension shaft 2-positions, all poles closed on the left and opened on the middle"
G NF2-63/HHDORYIM2 300mm(R)	514268	"63A, 6P, mechanical combination product, DIN rail installation, with lockable red and yellow handle and 300mm extension shaft 2-positions, all poles closed on the left and opened on the middle"
G NF2-63/HHRIM2 (R)	324169	"63A, 6P, mechanical combination product, DIN rail installation, with gray handle 2-positions, all poles closed on the left and opened on the middle"
G NF2-63/HHRIM31 (R)	324171	"63A, 6P, mechanical combination product, DIN rail installation, with gray handle 3-positions, all poles closed on the middle, left 3 poles closed on the left position, right 3 poles closed on the right position"

Product Reference	Ordering Code	Description
G NF2-63/HHRIM32 (R)	324174	"63A, 6P, mechanical combination product, DIN rail installation, with gray handle 3-positions, all poles opened on the middle, left 3 poles closed on the left position, right 3 poles closed on the right position"
G NF2-80/3BO (R)	324163	80A, 3P, plastic enclosure, with lockable black handle
G NF2-80/3BORY(R)	557276	80A, 3P, plastic enclosure, with lockable red and yellow handle
G NF2-80/3DIR (R)	324162	80A, 3P, DIN rail installation, with gray handle
G NF2-80/3DO(R)	540341	80A, 3P, DIN rail installation, without handle and extension shaft
G NF2-80/3DOB (R)	324138	80A, 3P, DIN rail installation, with straight black handle and 135mm extension shaft
G NF2-80/3DOBR (R)	324139	80A, 3P, DIN rail installation, with lockable black handle and 135mm extension shaft
G NF2-80/3DORY 300mm(R)	529742	80A, 3P, DIN rail installation, with lockable red and yellow handle, and 300mm extension shaft
G NF2-80/3DORY (R)	324137	80A, 3P, DIN rail installation, with lockable red and yellow handle, and 135mm extension shaft
G NF2-80/3H(R)	557285	80A, 3P, panel installation, without handle
G NF2-80/3HB (R)	324135	80A, 3P, panel installation, with gray handle
G NF2-80/3HBR (R)	324136	80A, 3P, panel installation, with lockable black handle
G NF2-80/3HRY (R)	324134	80A, 3P, panel installation, with lockable red and yellow handle
G NF2-80/HHRIM2 (R)	324168	"80A, 6P, mechanical combination product, DIN rail installation, with gray handle 2-positions, all poles closed on the left and opened on the middle"
G NF2-80/HHRIM31 (R)	324172	"80A, 6P, mechanical combination product, DIN rail installation, with gray handle 3-positions, all poles closed on the middle, left 3 poles closed on the left position, right 3 poles closed on the right position"
G NF2-80/HHRIM32 (R)	324175	"80A, 6P, mechanical combination product, DIN rail installation, with gray handle 3-positions, all poles opened on the middle, left 3 poles closed on the left position, right 3 poles closed on the right position"
G NF2-80PD (R)	324200	additional pole for 80A frame size, pre-disconnected, DIN rail installation
G NF2-80PDR (R)	324212	additional pole for 80A frame size, pre-disconnected, panel installation
G NF2-80PE (R)	324202	additional pole for 80A frame size, terminal for grounding, DIN rail installation
G NF2-80PER (R)	324214	additional pole for 80A frame size, terminal for grounding, panel installation
G NF2-80PN (R)	324201	additional pole for 80A frame size, terminal for N pole, DIN rail installation
G NF2-80PNR (R)	324213	additional pole for 80A frame size, terminal for N pole, panel installation
G NF2-80PS (R)	324199	additional pole for 80A frame size, sync disconnected, DIN rail installation
G NF2-80PSR (R)	324210	additional pole for 80A frame size, sync disconnected, panel installation
G NF2-80TS1 (R)	324221	Transparent terminal cover for 80A frame size, 1P
G NF2-80TS3 (R)	324222	Transparent terminal cover for 80A frame size, 3P
G NF2-P1 (R)	324152	auxiliary contact module, 1NO+1NC
G NF2-P2 (R)	324153	auxiliary contact module, 2NO
G NF2-25/3BA (R)	571364	25A, 3P, aluminium alloy enclosure, with lockable black handle
G NF2-32/3BA (R)	571365	32A, 3P, aluminium alloy enclosure, with lockable black handle
G NF2-40/3BA (R)	571366	40A, 3P, aluminium alloy enclosure, with lockable black handle
G NF2-63/3BA (R)	571367	63A, 3P, aluminium alloy enclosure, with lockable black handle
G NF2-80/3BA (R)	571368	80A, 3P, aluminium alloy enclosure, with lockable black handle
G NF2-40/3DIR (R)	324158	40A, 3P, DIN rail installation, with gray handle