

## EFEN<sup>3</sup>-current transformer block, size 1 – 3 for terminal space, standard or PTB-compliant variant

### Technical data

Order no. standard	77287-1636	77287-1736	77287-1846	77287-1946	77287-2146
Order no. for billing purposes	77587-1636	77587-1736	77587-1846	77587-1946	77587-2146
Primary rated current	200 A	250 A	300 A	400 A	600 A
Secondary rated current	2,5 A	2,5 A	5 A	5 A	5 A
Rated power	5 VA	5 VA	5 VA	5 VA	5 VA
Class	KL.0,5 s	KL.0,5 s	KL.0,5 s	KL.0,5 s	KL.0,5 s
Frequency	50-60 Hz	50-60 Hz	50-60 Hz	50-60 Hz	50-60 Hz
Insulation level	0,72/3 kV	0,7/3 kV	0,7/3 kV	0,72/3 kV	0,7/3 kV
Overcurrent limiting factor	FS5	FS5	FS5	FS5	FS5
Insulating material class	E	E	E	E	F
Thermal rated short-term current	60* I <sub>n</sub> max. 50 kA				
Thermal rated uninterrupted current	1,2* I <sub>n</sub>	1,2* I <sub>n</sub>	1,2* I <sub>n</sub>	1,2* I <sub>n</sub>	1,2* I <sub>n</sub>
Extended current range	120 %	120 %	120 %	120 %	120 %
Ambient temperature	-5° ... +40°C	-5° ... +40°C	-5° ... +40°C	-5° ... +40°C	-5° ... +40°C
Standards	VDE0414T 44-1, IEC60044-1				
Torque f. secondary terminals	1.5 to 2 Nm				

### Current transformer block for NH Fuse-Switches

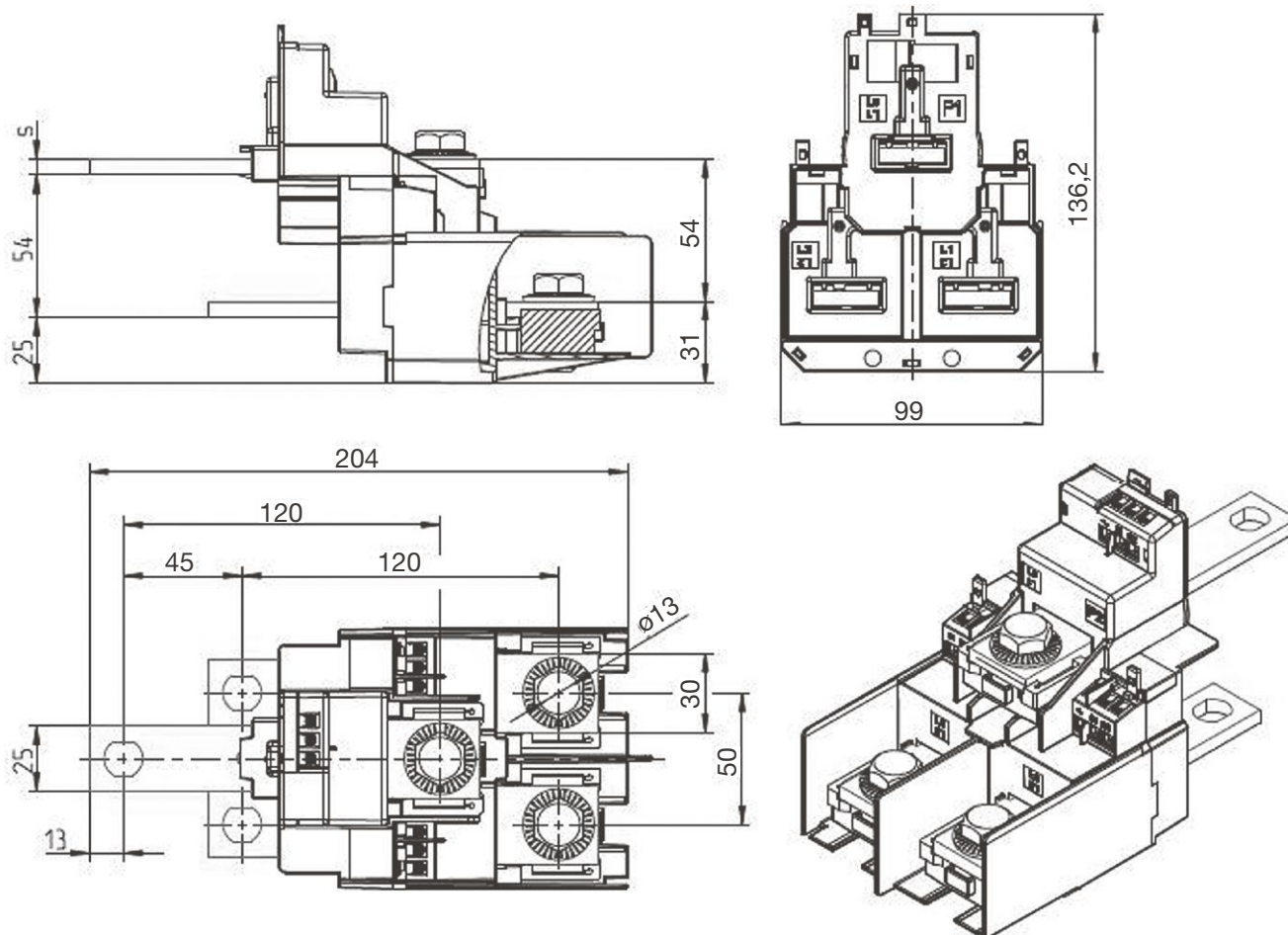

# E<sup>3</sup>-Current transformer block size 00/100 1-phase or 3-phase metering (1-phase at L1)

## Technical data

Article designation	Ratio	VA output	Class	Order no.
E <sup>3</sup> WB00/100 3X100/1 1,25 VA KL.1	3 x 100/1	1,25	1	77283-6313
E <sup>3</sup> WB00/100 3X150/1 2,5 VA KL.1	3 x 150/1	2,5	1	77283-6533
E <sup>3</sup> WB00/100 3X150/1 2,0 VA KL.0,5	3 x 150/1	2,0	0,5	77283-6522
E <sup>3</sup> WB00/100 1X100/1 1,25 VA KL.1	1 x 100/1	1,25	1	77284-6313
E <sup>3</sup> WB00/100 1X150/1 1,25 VA KL. 1	1 x 150/1	1,25	1	77284-6533
E <sup>3</sup> WB00/100 3X150/5 1,5 VA KL.1	3 x 150/5	1,5	1	77283-1523
E <sup>3</sup> WB00/100 1X150/5 1,5VA KL.1	1 x 150/5	1,5	1	77284-1523

Description	Unit	Value
<b>Electrical parameters</b>		
Technical data acc. to VDE 0414 T44-1/ IEC/EN 60044-1		
Primary rated current I1N	A	See transformer
S IN2	A	See transformer
Rated frequency	Hz	50
Rated isolation level	kV	0,72 / 3,00
Thermal rated uninterrupted current	A	1,2 x I <sub>n</sub>
Thermal rated short-time current I <sub>th</sub>		60 x I <sub>n</sub> ; max. 50 kA
Permissible ambient temperature	°C	- 40 to + 40 °C
Extended current range		120%
Insulation class acc. to IEC 60085 E	3 x 100/1	E <sup>3</sup> Zub.
Conductor connection	3 x 100/1	E <sup>3</sup> Zub.
Connection of secondary terminal	mm <sup>2</sup>	2,5 - 4
Torque of secondary terminal	Nm	0,8

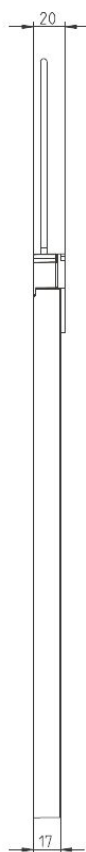
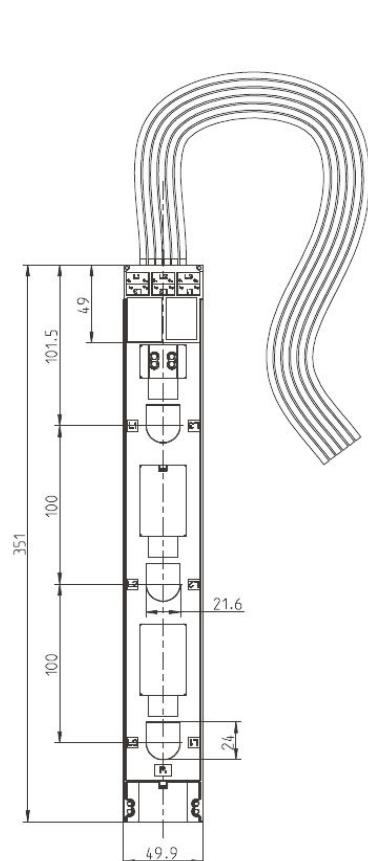

Connection of assembled end pieces for ratio to 5 Amps Cable length 2 m.

Converter terminals top / cable terminal bottom:

L1 / S1 = black  
S2 = brown  
L2 / S1 = gray  
S2 = white  
L3 / S1 = blue  
S2 = red

Converter terminals bottom / cable terminal top:

L1 / S1 = blue  
S2 = red  
L2 / S1 = gray  
S2 = white  
L3 / S1 = black  
S2 = brown

## E<sup>3</sup>-Drop-in transformers of size 1 – 3, PTB-compliant variant for billing purposes for E<sup>3</sup> NH Fuse-Switches, vertical design, size 1 – 3

### Technical data

Article designation	Ratio	VA output	Class	Order no.
E_E <sup>3</sup> W1-3 250/5A 2,5VA Kl.0,5	250/5	2,5	0,5	77550-1732
E_E <sup>3</sup> W1-3 300/5A 2,5VA Kl.0,5s	300/5	2,5	0,5s	77550-1836
E_E <sup>3</sup> W1-3 400/5A 5VA Kl.0,5s	400/5	5	0,5s	77550-1946
E_E <sup>3</sup> W1-3 600/5A 5VA Kl.0,5s	600/5	5	0,5s	77550-2146
E_E <sup>3</sup> W1-3 800/5A 5VA Kl.0,5s	800/5	5	0,5s	77550-2346
Cable holder E <sup>3</sup> size 1 – 3				36382-0010

Description	Unit	Value
Electrical parameters		
Technical data acc. to VDE 0414 T44-1/ IEC/EN 60044-1		
Primary rated current I <sub>1N</sub>	A	See transformer
Secondary rated current I <sub>N2</sub>	A	See transformer
Rated frequency	Hz	50
Rated isolation level	kV	0,72 / 3,00
Thermal rated uninterrupted current	A	1,2 x I <sub>n</sub>
Thermal rated short-time current I <sub>th</sub>		60 x I <sub>n</sub> ; max. 50 kA
Permissible ambient temperature	°C	- 5 to + 40 °C
Extended current range		120%
Insulating material class acc. to IEC 60085		E
Connection of secondary terminal	mm <sup>2</sup>	2,5 - 4
Torque of secondary terminal	Nm	0,8

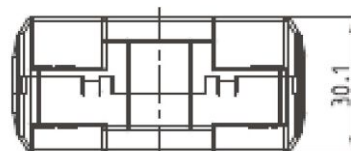
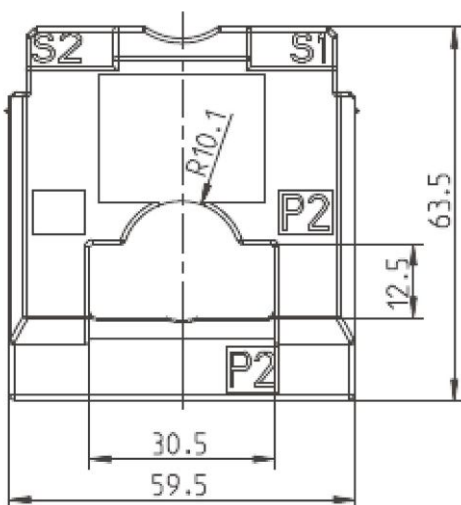

## Ε3-Current transformers

### Technical data

#### Current transformer block and current transformer class 0.5 s

Technical data acc. to VDE 0414 T 44-1 / IEC/EN 60044-1

Primary rated current	$I_{1N}$	300 A, 600 A, 800 A
Secondary rated current	$I_{2N}$	5 A
Rated frequency		50-60 Hz
Maximum voltage at equipment	$U_m$	720 V
Rated power-frequency withstand current (impulse-withstand voltage)		3 kV
Instrument security factor (FS)		FS 5
Thermal rated uninterrupted current		$1,2 \times I_{1N}$
Current rating		120% 800 A = 100%
Thermal rated short-time current		$I_{th} = 60 \times I_{1N}$ max. 50 kA
Rated dynamic current		$I_{dyn} = 2,5 \times I_{th}$ max. 120 kA
Permissible ambient temperature		-25° C to +55° C
Insulating material class acc. to IEC 60085		E
Degree of protection DIN/EN 60529/VDE 0470 T1		IP 20
Enclosure type		Closed enclosure
Enclosure material		Polyamide 6
Connection of secondary terminal		Box clamp 1.5 – 4 mm <sup>2</sup>
Torque of secondary terminal		0,8 Nm
Approved for official calibration		System number

#### Current transformer, class 1

Technical data acc. to VDE 0414 T 44-1 / IEC/EN 60044-1

Primary rated current	$I_{1N}$	150-1000 A
Secondary rated current	$I_{2N}$	1 and 5 A
Rated frequency		50-60 Hz
Maximum voltage at equipment	$U_m$	720 V
Rated power-frequency withstand current (impulse-withstand voltage)		3 kV
Instrument security factor (FS)		FS 5
Thermal rated uninterrupted current		$1,2 \times I_{1N}$
Current rating		120% 1000 A = 100%
Thermal rated short-time current		$I_{th} = 60 \times I_{1N}$ max. 50 kA
Rated dynamic current		$I_{dyn} = 2,5 \times I_{th}$ max. 120 kA
Permissible ambient temperature		-25° C to +55° C
Insulating material class acc. to IEC 60085		E
Degree of protection DIN/EN 60529/VDE 0470 T1		IP 20
Enclosure type		Closed enclosure
Enclosure material		Polyamide 6
Connection of secondary terminal		Box clamp 1.5 – 4 mm <sup>2</sup> , strand with end sleeve
Torque of secondary terminal		0,8 Nm

#### Recommended wiring for current transformer of class 1

Halogen-free multiple-strand wiring 2.5 mm<sup>2</sup> Temperature resistance 105 °C Test voltage 2500 V