

# UA ETIMAT P10

## Navodila za montažo

### Assembly instruction

1. Vstavite prenosnik na desno stran instalacijskega odklopnika ETIMAT P10  
*Insert the mechanical piece on the right side of MCB ETIMAT P10*

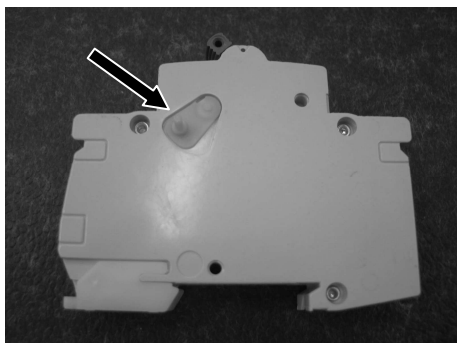

2. Vstavite pregrado na instalacijski odklopnik ETIMAT P10  
*Insert the barrier on the MCB ETIMAT P10*

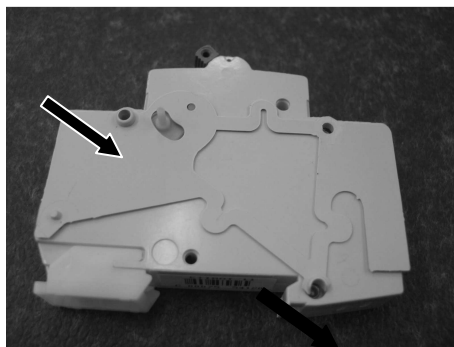

3. Vstavite povezovalno os v gumb UA ETIMAT P10  
*Insert the metallic latch in the ON/OFF handle of UA ETIMAT P10*

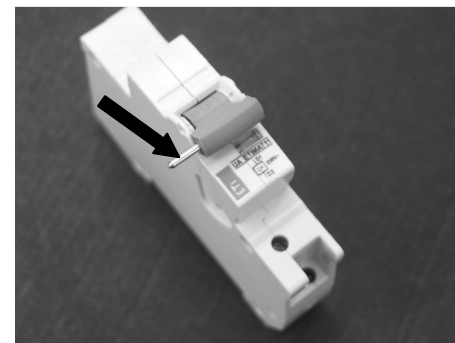

4. Sestavite skupaj instalacijski odklopnik ETIMAT P10 in UA ETIMAT P10  
*Assemble together MCB ETIMAT P10 and UA ETIMAT P10*

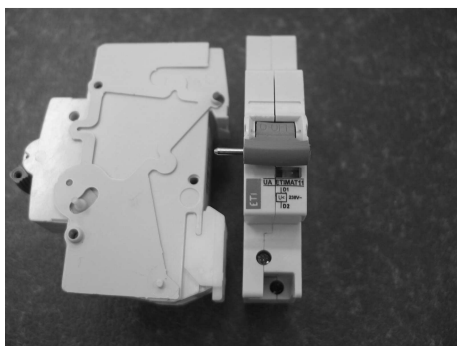

5. S povezovalnimi sponkami povežite skupaj oba aparata; zgoraj dvakrat, spodaj enkrat  
*Connect both devices together with connecting clamps; twice on the upper side, once on the lower side*

