

Product Datasheet

JLK5015

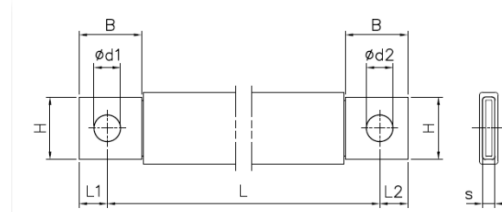

Main

| | | |
|----------------------------------|---|---------------------|
| Family | Insulated copper braided shunts | |
| Version | J-link Plus | |
| Code | JLK5015 | |
| Reference | JLP 25-530 | |
| Number per package | 10 | |
| Weight (kg) | 0.20 | |
| L: Hole to hole length (mm) | 530 ^{+3.6} _{-0.6} | |
| Cross section (mm ²) | 25 | |
| Dimensions (mm) | B = 20 ^{+0.5} _{-0.5} , H = 20 ^{+0.5} _{-0.5} , L1 = 7.5 ^{+0.3} _{-0.3} , L2 = 8 ^{+0.3} _{-0.3} , d1=8.5 ^{+0.3} _{-0.3} , d2=10.5 ^{+0.3} _{-0.3} , s=4.3 ^{+0.5} _{-0.5} | |
| In (A) vs ΔT (°C) | Rated Intensity (A) | Temperature rise ΔT |
| | 144 | 35 °C |
| | 181 | 55 °C |
| | 203 | 70 °C |
| | 245 | 105 °C |

Technical Features

Conductor

Tinned electrolytic copper braid Cu-ETP

99.90%

Standard wire: 0.20 mm

Terminal in tinned copper tube

Insulation

TPE Compound

Black color with a light blue

Low smoke emission

Self-extinguishing UL 94-V0

Thickness: 1.9 ± 0.1 mm

Halogen-free

Class II according to Par. 8.4.4 IEC 61439-1

Recyclable

Finished Product

Dielectric rigidity: 20 kV/mm

Rated voltage: 1000 V AC/1500 V DC

Working temperature: -40 °C to 140 °C

In vs. ΔT

I_n = Rated current A

ΔT = Temperature rise °C

Standard IEC 61439-1

Reference Room temperature is 35 °C

For derating coefficient for the use of bars in parallel please refer to the catalogue.

Please contact Teknomega for non-specified tolerances.